



filinox



GUIDE TO APPLICATIONS BY SECTOR

PIPES AND FITTINGS

[Instalpress]

[Firepress]

SYSTEM ELASTOMER TECHNICAL DATA

The sealing material used by **FILINOX, S.A.** for the precedent joined is EPDM (ethylene propyl- ene) and is factory-fitted in the system's pressfittings. The gasket has a contour, so that any unpressed spots are immediately recognisable. This elastomer is consistent with the German Health Authority's KTW recommendation requirements and is especially suitable for drinking water applications.

FILINOX, S.A. supplies the following gaskets for other applications:

GASKET TYPES AND SPECIFICATIONS

EPDM, black	FPM (DIN ISO 1629) / FKM (ASTM D1418), green	FPM (DIN ISO 1629) / FKM (ASTM D1418), red
Temp: -10°C - +110°C (120°C) Diameter: Ø12 - Ø108mm	Temp: -30°C - +160°C (200°C) Diameter: Ø15 - Ø108mm	Temp: -30°C - +160°C (200°C) Diameter: Ø15 - Ø108 mm
		
Applications: <ul style="list-style-type: none"> • Drinking water • Delible water • Rainwater • Heating installations • Circulation pipes • Fire fighting protection systems 	Applications: <ul style="list-style-type: none"> • Air pressure systems • Vapour and compressed air systems • Solar power installations • Cooling installations • Hydrocarbons, except diesel • Mineral, vegetable and synthetic oils 	Applications: <ul style="list-style-type: none"> • Air pressure systems • Mineral, vegetable and synthetic oils • Grease and industrial applications • Hydrocarbons, (except heavy diesel) • Liquid gases (LPG)

PRESSFITTING MATERIALS

	Instalpress INOX	Instalpress STEEL
DRINKING WATER	Suitable	Not suitable
HEATING	Suitable	Suitable Outside galvanised pipe
SOLAR	Suitable with FKM (green)	Suitable with FKM (green)
GAS	Not suitable	Not suitable
FUEL (DIESEL)	Suitable with FKM (red)	Suitable with FKM (red)
PRESSURISED AIR	Suitable up to Class 4 Class 5, with FKM (green)	Suitable up to Class 4 Class 5, with FKM (green)
RAINWATER	Suitable	Not suitable
CONDENSED STEAM	Suitable with FKM (green)	Not suitable
INDUSTRY	On request	On request
PCI (BIES / SPRAYER)	Suitable	Suitable Inside / outside galvanised pipe
WELL WATER	Not suitable	Not suitable

INOX STEEL A-316 L



CARBON STEEL



INSTALPRESS INOX AND INSTALPRESS STEEL PREPARATION AND ASSEMBLY

TRANSPORT AND STORAGE

In transport and storage **Instalpress INOX** and **Instalpress STEEL** systems pipes and fittings are to be protected against damage, moisture, UV-radiation and dirtiness.

SEPARATION AND DE-BURRING

Instalpress system pipes can be cut to length using commercial cutting tools suitable for metallic materials. It should be ensured that tarnishing does not result from performing cutting procedures on **Instalpress INOX** and **Instalpress STEEL**.

The use of the following tools is recommended:

- Pipe cutters
- Fine-toothed hand saws
- Slow running electronic machine saws.

The following tools are not permitted:

- Tools that cause tarnishing
- Oil-cooled saws
- Angle grinders.

After cutting procedures, the pipe ends must be finished internally and externally with a commercial device for processing stainless steel or a suitable file. This guarantees safety on inserting the pipe section into the pressure fittings, otherwise the joint may be damaged.

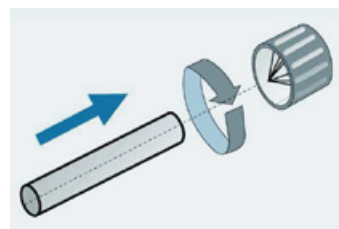

MARKING THE DEPTH OF THE INSERTION

To get a correct and secure pressfitting connection:

a) Before assembly, the required insertion depth "A" must be marked on the pipes. The insertion depth is marked with the respective gauge and an indelible marker (Fig. 1).



Fig. 1

b) The joint's mechanical resistance can only be ensured by respecting the insertion depth "A" specified. When the pipe is inserted into the fitting, the mark should be just on the edge of the fitting ring (Fig. 2).



Fig. 2



Fig. 3

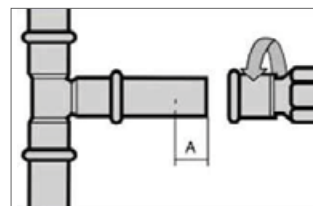
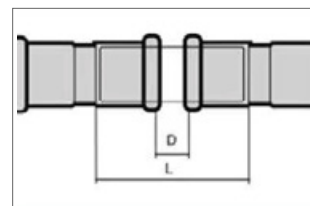
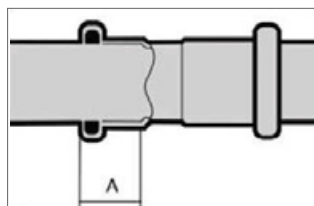

c) Pressfittings with insertable ends such as reductions, bent pipes, male-female elbows, deflection elbows or plugs must be marked prior to assembly with the insertion depths "A" specified (Fig. 3).

d mm	Insertion depth "A" mm	"D" - Min. distance between presses mm	Insertion depth "L" mm
15	20	10	50
18	20,5	10	51
22	21,5	10	53
28	23	10	56
35	25	10	60
42	30	20	80
54	35	20	90
76,1	53	30	130
88,9	60	30	150
108,0	75	30	180

WINE CELLAR



INDUSTRIAL KITCHENS



WATER TREATMENTS



OSMOSIS PLANTS



SOLAR ENERGY



COMPRESSED AIR



PETROCHEMISTRY



NAVAL INDUSTRY



FARMS AND LIVESTOCK INDUSTRY

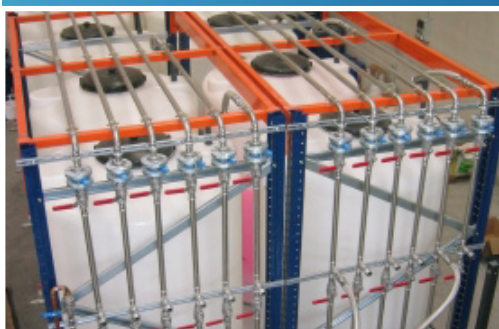

COUNTERS ROOMS



AIR CONDITIONING



LAUNDRIES



FIRE PRESS

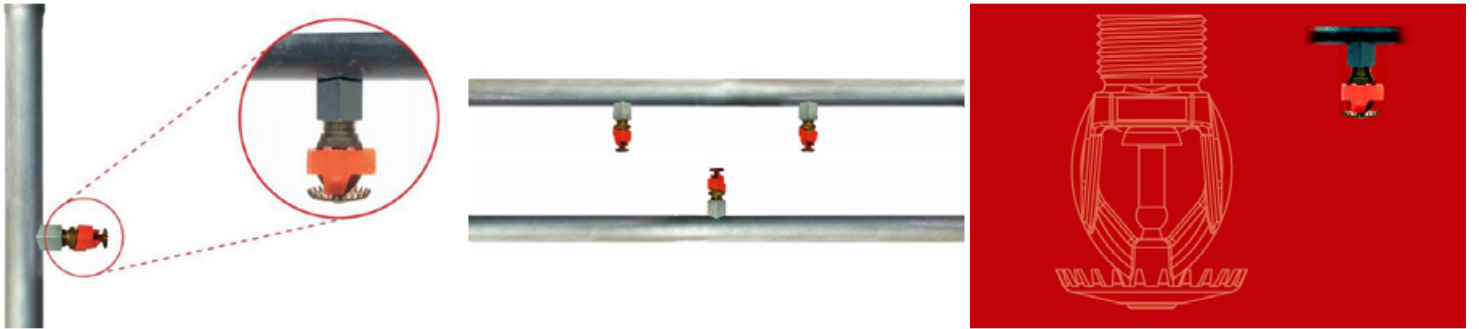

FIXED FIREFIGHTING SYSTEMS



FIRE PRESSURE GROUPS



FACILITIES





filinox

OFFICES

C/ Sant Adrià, 76, 08030 Barcelona (Spain)
Tel. +34 932 232 662 / Fax. +34 932 232 662
e-mail: customer@inoxidables.com
Visit us in: www.inoxidables.com

FACTORY / LOGISTICS

C/ Caçadors, s/n
08799 La Torre de Claramunt (Barcelona)



8 435177 233159 >